

25500786 A0 0322

## Safety Message to Installers of Warning Light Equipment

### ⚠ WARNING

*To properly install this light, you must have a good understanding of automotive electrical procedures and systems, along with proficiency in the installation and use of safety warning equipment. Before installing this device, refer to document number 25500119, which is available online at [www.fedsig.com](http://www.fedsig.com). Print the online document and provide copies to the end users of this product and to the personnel who will service it.*

## Installing the Light Head

To +Vdc (fuse at 1 A): .....**RED**

To Chassis Ground: .....**BLACK**

For Synchronization: ...**YELLOW**

Connect the **YELLOW** wires of all of the heads together for synchronization. (All heads must be set at the same pattern.)

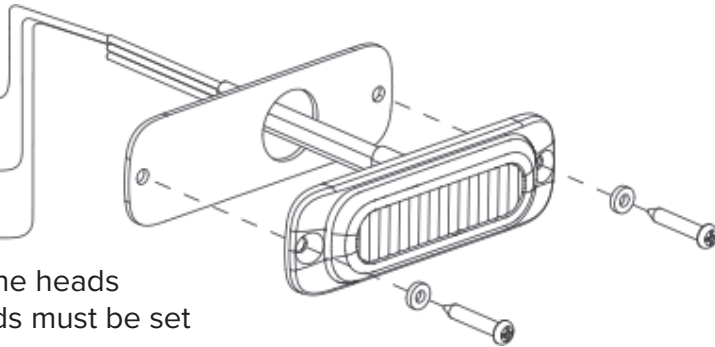

## Simultaneous or Alternating Flash

- Apply +Vdc to the **RED** and **YELLOW** wires simultaneously to enter grouping mode. The light head displays short (single or double) flashes:
  - Single flash = Group1
  - Double flash = Group2
- Remove the **YELLOW** wire from +Vdc and momentarily apply it to +Vdc again to change groups:
  - Heads in the same group flash together.
  - Group1 Heads alternate with Group2 Heads.

## Flash Pattern

To apply a Flash Pattern, momentarily apply +Vdc to the **YELLOW** wire:

- once for the next pattern
- quickly three times to reset to FP#1

See the flash pattern chart.

**NOTE:** This unit may not be factory set at Flash Pattern 1.

FP#	Flash Patterns		
1	Random	7	Quad
2	Steady	8	Quint
3	Single	9	8 Flash
4	Mega	10	Single-Quad
5	Double	11	Single H/L
6	Triple	12	Single-Triple-Quint

## **Getting Repair Service**

The Federal Signal factory provides technical assistance with any problems that cannot be handled locally.

Any units returned to Federal Signal for service, inspection, or repair must be accompanied by a Return Material Authorization (RMA). Obtain an RMA from a local Distributor or Manufacturer's Representative.

Provide a brief explanation of the service requested or the nature of the malfunction.

Address all communications and shipments to the following:

Federal Signal Corporation  
Service Department  
2645 Federal Signal Drive  
University Park, IL 60484-3167

## **Ordering Replacement Parts**

To order replacement parts, call Customer Support at 1-800-264-3578, 7 a.m. to 5 p.m., Monday through Friday (CT), or contact your nearest distributor.

## **Limited Warranty**

This product is subject to and covered by a limited warranty, a copy of which can be found at [www.fedsig.com/SSG-Warranty](http://www.fedsig.com/SSG-Warranty). A copy of this limited warranty can also be obtained by written request to Federal Signal Corporation, 2645 Federal Signal Drive, University Park, IL 60484, email to [info@fedsig.com](mailto:info@fedsig.com) or call +1 708-534-3400.

This limited warranty is in lieu of all other warranties, express or implied, contractual or statutory, including, but not limited to the warranty of merchantability, warranty of fitness for a particular purpose and any warranty against failure of its essential purpose.



**FEDERAL SIGNAL**  
Safety and Security Systems

2645 Federal Signal Drive  
University Park, Illinois 60484-3167

[www.fedsig.com](http://www.fedsig.com)

Customer Support

Police/Fire-EMS: 800-264-3578 • +1 708 534-3400

Work Truck: 800-824-0254 • +1 708 534-3400

Technical Support: 800-433-9132 • +1 708 534-3400

© Copyright 2022 Federal Signal Corporation

All product names or trademarks are properties of their respective owners.