

25500231 Rev. A1 0516

## **Safety Message to Installers and Service Personnel of Emergency Vehicle Safety Equipment**

### **⚠ WARNING**

The lives of people depend on your proper installation and servicing of Federal Signal products. It is important to read and follow all instructions shipped with this product. In addition, listed below are some other important safety instructions and precautions you should follow:

#### **Before Installation or Service**

##### *Qualifications*

- To properly install or service this equipment, you must have a good understanding of automotive electrical procedures and systems along with proficiency in the installation and service of safety warning equipment. Always refer to the vehicle service manuals when installing equipment on a vehicle.

##### *Electrical Hazards*

- Never attempt to install aftermarket equipment that connects to the vehicle wiring without reviewing a vehicle wiring diagram available from the vehicle manufacturer. Ensure that your installation will not affect vehicle operation and safety functions or circuits.

#### **During Installation or Service**

- To avoid a battery explosion, always disconnect the negative battery cable first and reconnect it last. Avoid a spark when connecting near or to the battery. The gasses produced by a battery can cause a battery explosion that could result in vehicle damage and serious injury.
- Do not install equipment or route wiring or a plug-in cord in the deployment path of an airbag.
- Before mounting any components, check the manual to be sure that the component you are installing is suitable for use in that area of the vehicle. Many components are not suitable for use in the engine compartment or in other areas subject to extreme environmental exposure.
- When drilling into a vehicle structure, be sure that both sides of the surface are clear of anything that could be damaged. Remove all burrs from drilled holes to prevent electrical shorts, grommet all drilled holes through which wiring passes. Also ensure that mounting screws do not cause electrical or mechanical damage to the vehicle.

#### **After Installation or Service**

- If a vehicle seat is temporarily removed, verify with vehicle manufacturer if the seat needs to be recalibrated for proper airbag deployment.
- To ensure proper operation, test all vehicle functions, including horn operation, vehicle safety functions, and vehicle light systems. Ensure that installation has not affected vehicle operation or changed any vehicle safety function or circuit.
- After installation and testing are complete, provide a copy of these instructions to instructional staff and all operating personnel.
- File these instructions in a safe place and refer to them when maintaining and/or reinstalling the product.

Failure to follow all safety precautions and instructions may result in property damage, serious injury, or death.

## Unpacking the Product

After unpacking the product, inspect it for damage that may have occurred in transit. If it has been damaged, do not attempt to install or operate it. File a claim immediately with the carrier, stating the extent of damage. **Failure to identify damage before installation could lead to rejection of any claim.** Carefully check all envelopes, shipping labels, and tags before removing or destroying them. Ensure that the parts listed in Table 1 are included in the package. If you are missing any parts, contact Federal Signal Customer Support at 1-800-264-3578, 7 a.m. to 5 p.m., Monday through Friday (CT). Disposal of all shipping materials must be carried out in accordance with national and local codes and standards.

### **⚠ WARNING**

***PUSH BUMPER PRECAUTION: Installing a push bumper on a vehicle may raise the vehicle's minimum collision speed for airbag deployment. It is imperative that police officers wear safety belts when operating their motor vehicle. Failure to follow this warning may cause serious injury or death.***

### **NOTICE**

***THREAD DAMAGE AND GALLING: To prevent thread damage and galling, anti-seize lubricant must be used on all stainless steel fasteners.***

**Table 1** Kit contents and tools needed (Figure 1)

Item	Qty.	Description	Tools Needed
1	2	Wing Wrap Assemblies (driver side shown)	Ratchet
2	2	M12 Button-Head Screw (Black Plated S.S.)	18 mm Socket
3	2	M12 Cupped Washer (Black Plated S.S.)	16 mm Socket
4	2	M12 Flange Nut (Black-Plated S.S.)	10 mm Socket
5	4	M10 Button-Head Screw (Black Plated S.S.)	Allen Wrench
6	4	M10 Cupped Washer (Black Plated S.S.)	Torque Wrench
7	4	M10 Flange Nut (Black-Plated S.S.)	--
8	4	M6 Button-Head Screw (Black Plated S.S.)	--
9	4	M6 Flat Washer (Black Plated S.S.)	--
10	4	M6 Flange Nut (Black Plated S.S.)	--

To install the wing wrap:

1. Install the police push bar (PBX-02, PBX-05) and pit bar sets (PBX-PIT02, PBX PIT05) to the front of the vehicle. Refer to 25500238 and 25500243 for the Sedan and 25500233 and 25500250 for the Utility.

**NOTE:** The pit bar set is necessary to properly install the wing wraps.

2. One side at a time, use the supplied M12 and M6 hardware to loosely install each wing wrap to the push-bar uprights.
3. Use the supplied M10 hardware to loosely attach the foot of each wing to the upper rail of each pit bar.
4. Align and adjust the wing wraps as necessary, then tighten and torque all fasteners as follows:

M6 to 7-9 ft-lb

M10 to 30-35 ft-lb

M12 to 50-55 ft-lb.

**Figure 1** PBXW-FPIS13 and PBXW-FPU16

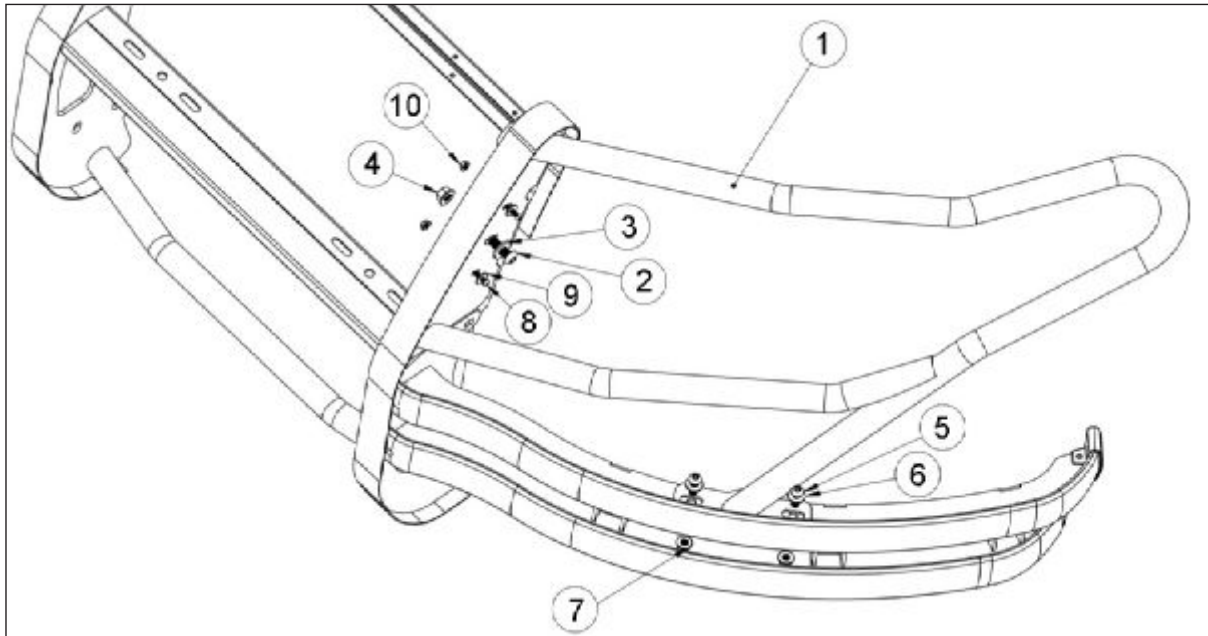

## **Maintaining the Wing Wrap**

Regularly clean stainless steel and gloss black finishes with a mild soap and water. Apply a non-abrasive wax or polish. To polish small scratches on stainless steel, use stainless steel polish. To avoid making scratches on the stainless steel surfaces, follow the grain of the steel while polishing.

## **Getting Technical Support and Service**

Federal Signal Corporation will service your equipment or provide technical assistance with any problems that cannot be handled locally. Any product returned to Federal Signal for service, inspection, or repair must be accompanied by a Return Material Authorization number. The RMA number can be obtained from your local distributor or Federal Signal. Please provide a brief explanation of the service requested or the nature of the malfunction. Contact your local dealer/distributor for replacement parts availability or contact the Federal Signal Service Department (7 a.m. to 5 p.m., Monday through Friday, Central Time) at:

Service Department  
Federal Signal Corporation  
2645 Federal Signal Drive  
University Park, IL 60484-3167  
800-433-9132, 800-343-9706 (fax)

Police Interceptor is a registered trademark of the Ford Motor Company.



2645 Federal Signal Drive, University Park, IL 60484-3167  
Phone: 708-534-3400 • 800-264-3578 Fax: • (800) 682-8022  
[www.fedsig.com](http://www.fedsig.com)